

# WIDDER TOOLS



## 20006 6" Venturi Style Air Mover with Collapsible Horn



### *PRODUCT INFORMATION AND OPERATING INSTRUCTIONS*

**Description:** The **20006** 6" Venturi Style Air Mover is used to provide air circulation in hazardous areas with no moving parts and little to no maintenance necessary. The **20006** features the only collapsible horn on the market, allowing the unit to be stacked up to 3 high and stored in 1/3 the space of a traditional solid horn.

**Specifications:** 3600 CFM of air movement @ 100 PSI and 100 CFM compressed air input

**Weight:** 19 lbs.

**IMPORTANT: READ MANUAL CAREFULLY BEFORE OPERATING THIS TOOL.  
FOLLOW ALL SAFETY PRECAUTIONS LISTED AND ALL OSHA REGULATIONS  
PERTAINING TO THIS TOOL.**

## ***SAFETY PRECAUTIONS:***

**Warning: When using air tools, basic safety precautions should always be followed to reduce the risk of injury, including the following:**

1. **Maximum Air Pressure**
  - Maximum air pressure is 150 PSI.
  - Use clean, regulated air.
2. **Protect Airlines**
  - Avoid using excessive length airlines. Extended airlines reduce tool power and are a working hazard.
  - Inspect all airlines for safe condition before use.
3. **Dress Properly**
  - Do not wear loose clothing that could be sucked into the unit.
  - Wear ear protection.
  - Wear safety glasses.
4. **Ground Unit**
  - Always attach the Grounding Wire to a good ground source when operating the Air Mover.

## ***OPERATING INSTRUCTIONS:***

**Warning: Operator should be thoroughly familiar with safety precautions before attempting to operate this tool.**

### **1. Expanding Horn**

- Remove Retention Strap and clip to Carrying Handle for safe storage during Air Mover use.



- With the Base Casting sitting on the ground, or mounted to a vessel, grab the Large Horn Section and pull all the way out, seating all sections firmly.
- There is no need to over-pull, all sections assemble securely once seated.



## 2. Collapsing Horn

- Firmly push down on the Large Horn Section while rocking gently.
- Knock down all Horn Sections until they rest on the Base Casting.



- The Large Horn Section is seated on the three steps in the Base Casting.



- Secure the Retention Strap onto the tops of the four loose Horn Sections for secure handling and storage.



### 3. Stacking

- The WIDDER Venturi Style Air Mover is designed for easy, economical storage and transport.
- These units can be stacked up to 3-high, taking up only 1/3 of the space of traditional Air Horns.
- Simply place one Air Mover on top of another, being sure that the fixed Small Horn Section of the lower unit is seated in the locating ring in the Base Casting intake bell of the upper unit.



# WIDDER 6" Venturi Air Mover #20006

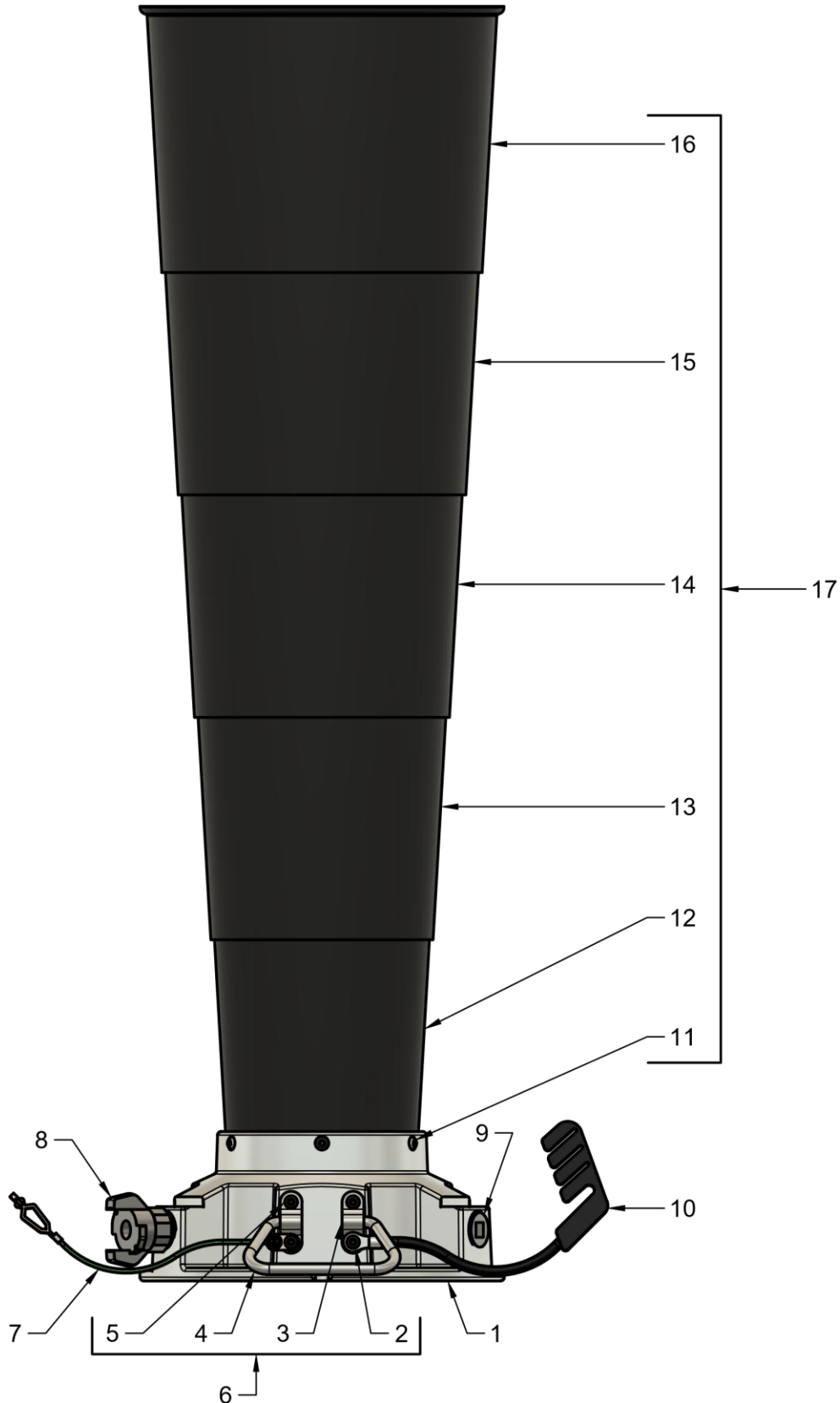

# **WIDDER 6" Venturi Air Mover #20006**

<b>Item</b>	<b>Part #</b>	<b>MFG #</b>	<b>Description</b>	<b>Qty</b>
1	20601	69-6001	Base Casting	1
2	20814	70-6014	Handle Screw, Short	2
3	20816	70-6008	Handle Bracket	2
4	20817	70-6007	Handle	1
5	20815	70-6009	Handle Screw, Long	2
6	20803	70-6007A	Handle Assy. (Handle, Brackets, Screws)	1
7	20203	06-0011	Ground Clip Assy.	1
8	20811	70-6011	Universal Coupling	1
9	20812	70-6012	Plug	2
10	20610	69-6010	Retention Clip Assy.	1
11	20813	70-6013	Horn Screw	6
12	20621	69-6002-1	Horn Section 1	1
13	20622	69-6002-2	Horn Section 2	1
14	20623	69-6002-3	Horn Section 3	1
15	20624	69-6002-4	Horn Section 4	1
16	20625	69-6002-5	Horn Section 5	1
17	20602	69-6002	Horn Assy. (5 Horn Sections, Horn Screws)	1